

## Kelker Well Roundhouse

### Preparing for your stay: cooking & kitchen utensils

There are a number of cooking options at the Roundhouse, including:

- **A Weber Kettle BBQ & tools**, 57cm, which can also be used as an oven & to cook pizzas. You just need to bring charcoal.
- **A wood burning stove with in-built oven** – internal dimensions: height: 20cm, width: 25cm and depth: 22cm.
- **Two gas stoves/ hobs**, gas canisters are included.

The following is provided in the Roundhouse:

Cooking & Baking	Crockery & Utensils	Accessories
Baking beans Baking tray medium x 2 Baking tray small x 2 Cake tin Casserole dish Chopping board Colander Digital scales Heat pads Japanese grill plate* Loaf tin Measuring jug Medium square roasting dish Mixing bowls Oval pie dish Pizza tray Rolling pin Sieve x 2 Small heart tin Small square roasting dish Stainless steel pans... frying pan, large pan, medium pan & three small pans	Clover Leaf crockery set including 6 bowls, small plates, large plates, cups & saucers, jugs and a small serving dish  Denby cutlery set & ProCook steak knives  12-piece utensil set and two wooden spoons  10-piece knife set with scissors  Bottle opener Masher Peeler Tin opener  2 Mugs	Apron Barbecue holders e.g. for sweetcorn Cafetière Cling film Dishcloths & Tea towels Egg cups x 4 Flask Grater Greaseproof paper Kitchen clips Kitchen foil Milk frother Nibble dishes Pestle & mortar Placemats Plastic glasses for the hot tub Skewers e.g. for marshmallows Sugar bowl Tea strainer Thermos cups Trays Tupperware Water bottle

**Store cupboard essentials:** tea, ground coffee, sugar, pepper, salt, granola, bread, milk, tomato ketchup, HP sauce, butter, oil. **Extra treats:** farm free-range eggs & cheese, Kendal mint cake, marshmallows, botte of cava & ice.

There is a fridge & freezer near the parking (useful for longer stays), a large coolbox in the shed on site and a small coolbox in the Roundhouse. Freezer packs are provided.

**If you have any questions about the above**  
e.g. if there is anything else you need, please get in touch.

\*See the next page for information about this more usual kitchen item!

**Japanese grill plate (to be used with the gas stoves):**



**INSTRUCTIONS**



Place the Water Tray on to the stove. Make sure that the pan supports of the stove fit into the indentations on the Water Tray so that the flames are directed at the center of the Plate.



Be sure to fill the receptacle about two-thirds full with water (approximately 9oz/260ml).



When removing the Plate or adding water, use the handle included.

**HOW TO USE THE HANDLE**

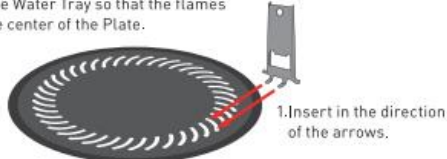

**WARNING**

- Keep out of the reach of children.
- Even after use, the BBQ Plate contains very hot water, never leave the plate unattended.
- Do not use any other cooking appliances other than Iwatani Portable Butane stove.

**CAUTION**

- Be sure to add water to the water tray when using this product. Not doing so can damage the non-stick coating, or cause deformations to the BBQ plate. If the water level drops during use, refill with water to ensure that the water tray always has water in it.
- During and after cooking, do not touch this product directly. Doing so may cause burns or other injuries.
- Depending on the butane stove being used, the BBQ Plate may slip. Be careful when handling it.
- Use an oven mitt or similar protection when handling the BBQ Plate.

**[OTHER CAUTIONS]**

- Before using this product for the first time, warm it slightly and then rub salad oil onto the Plate's surface.
- Do not use metal or other abrasive utensils. Doing so can damage the non-stick coating and reduce normal performance. Be sure to use a wooden, silicone or other non-abrasive utensils.
- Use it only over medium or lower heat.
- This product is dish washer safe. Do not use metal scrubbers, abrasive cleaners or similar items as they will damage the non-stick surface. If you leave the product unwashed, the food will stick to the surface, and removing it may damage or remove the non-stick coating.
- After washing the product, carefully wipe off all moisture and store it safely.
- Please note that depending on the size of the butane stove, this product may not be usable.